

Eclisse SINGLE



Single Sliding Pocket Door system

Simple, functional, strong and reliable: this is the essential sliding pocket door that brought sliding doors into the 21st century and is widely used throughout the industry for both new build and refurbishments.

A large range for both UK standard size doors and made-to-measure systems (for doors up to 2m wide and almost 3m high) is available.

So there are endless possibilities to transform your surroundings by creating new, usable space. You get more real space and a tangible transformation of any room.



Available Accessories

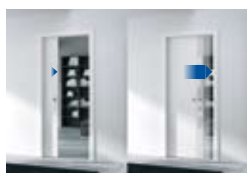

Soft Close

Allows the door to close softly - everytime, see page 38

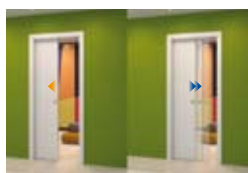

Self Closing Mechanism

The door closes automaticall by itself, see page 39

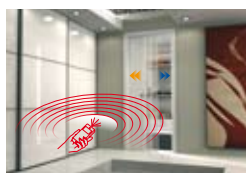

Motorisation

Motor driven open/close, see page 42



Door Furniture

Simple Flush Pulls and Bathroom furniture, see page 43

FRAMES FOR SINGLE DOORS

finished wall thickness 100 or 125 mm

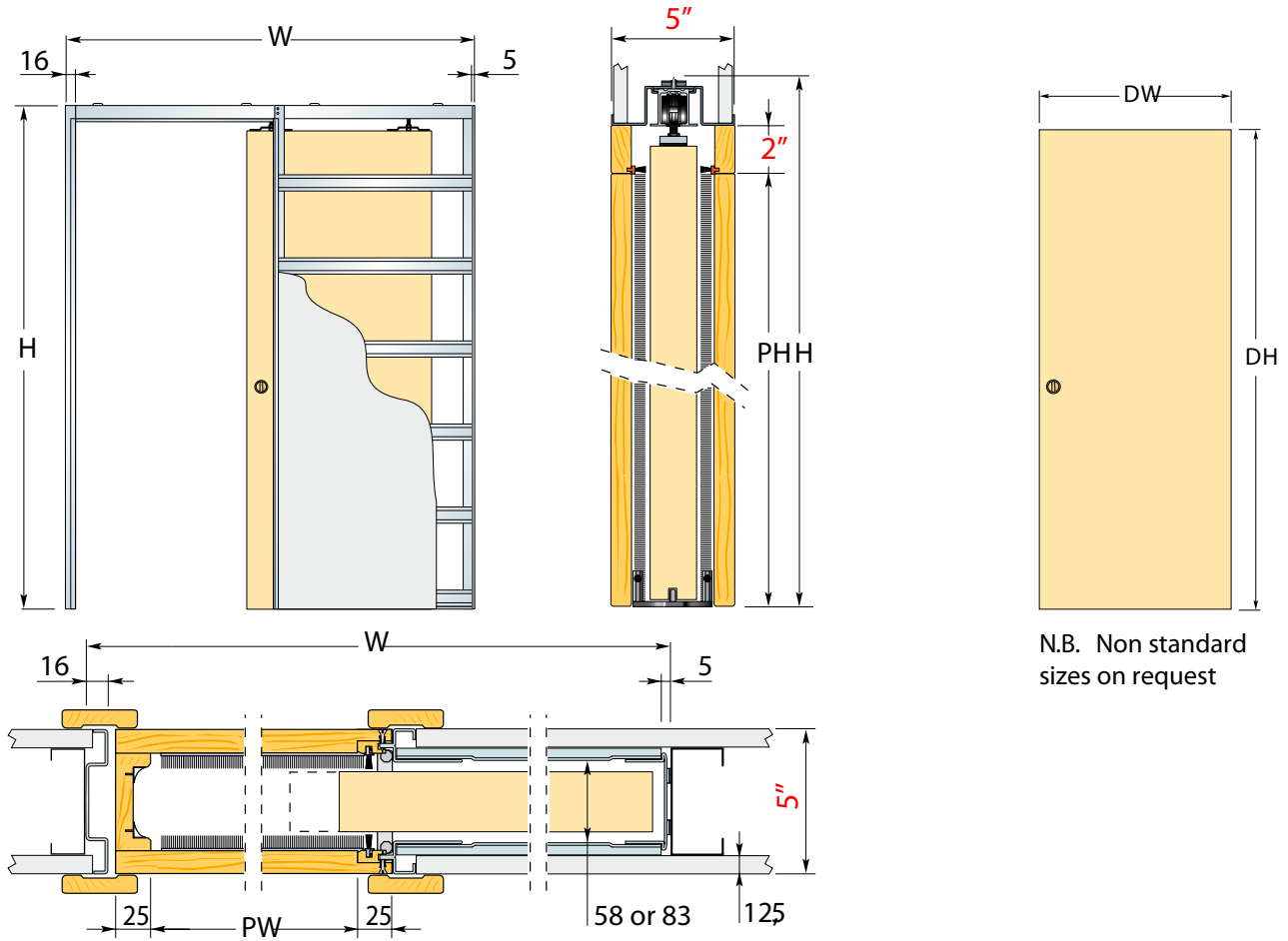

N.B. Non standard sizes on request

FRAMES FOR SINGLE DOORS

Max. Passage Size PW x PH	Overall Dimension W x H	Finished Wall
32" x 84"	67" x 86"	5"

NOTES

Suitable for use with 35 - 44 mm thick doors
Max. door weight 80 kg. (120 kg. on request)

When fitting flush pull handles we recommend the stop be regulated so the door protrudes from the pocket to avoid risk to fingers.

Should the door be set to enter the pocket completely we do not accept any liability.

Doors, plasterboard and final architrave not supplied.

dimensions are given in mm.